

AIR VORTEX

APPLICATIONS

- Pneumatic conveying systems.
- Vacuum lifting and clamping system
- Packaging and printing equipment
- Bag / bottle / hopper filling system
- Waster water treatment system
- Air-knife drying
- Food processing system
- Plastic and rubber industry
- Beverage industries
- Timber industry
- Environmental engineering
- Electronics / semiconductor industry
- Pharmaceutical industry
- Hospital and laboratory equipment
- Textile Industry



AIR VORTEX

The **Efficient**
engineering for
BLOWER
Manufacturing

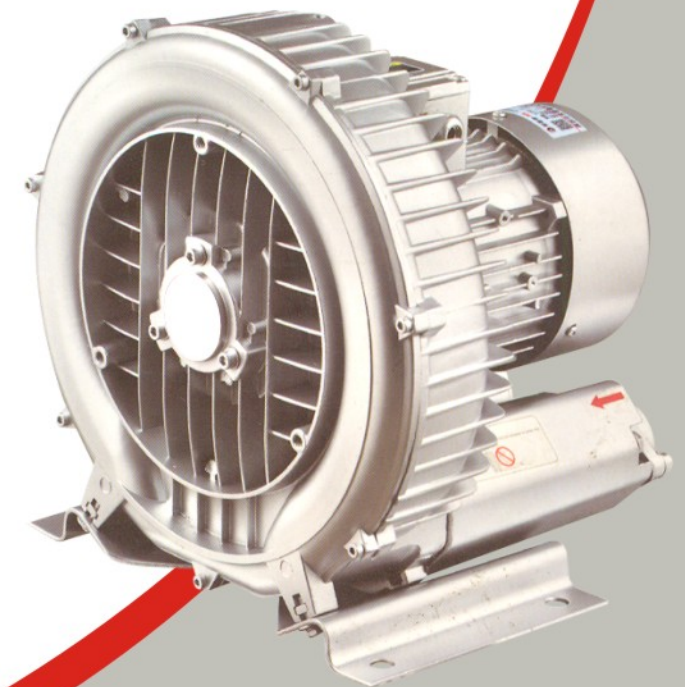



- Easy Installation
- Structure of the solid
- Low vibration
- Low Noise
- The protection class is Ip54 and Insulation class is F

- Voltage : 350 ~ 415
- Phase : 3
- RPM : 2880
- Frequency : 50 Hz ± 5%

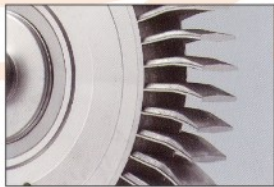

Dia casting aluminum impeller



Aluminum Alloy Die Casting Molding



Pure Copper Wire Motor

TECHNICAL PARAMETERS FOR THREE PHASE

MODEL	KW	V	A	NOISE DB	MAX AIR FLOW M ³ /hr.	RATED VACUUM Mbar	RATED PRESSURE Mbar
MVP 210	0.25	415Δ/ 220Δ	1.2/2.0	53	80	90	100
MVP 211	0.37	415Δ/ 220Δ	1.6/2.6	55	80	110	125
MVP 410	0.75	415Δ/ 220Δ	2.2/3.8	58	145	140	150
MVP 411	0.85	415Δ/ 220Δ	2.4/4.2	63	145	160	175
MVP 510	0.85	415Δ/ 220Δ	2.8/4.5	63	210	165	180
MVP 511	1.1	415Δ/ 220Δ	3.5/6.0	63	210	180	195
MVP 512	1.5	415Δ/ 220Δ	3.8/7.7	70	210	190	205
MVP 513	2.2	415Δ/ 220Δ	4.5/8.5	70	210	220	270
MVP 610	2.2	415Δ/ 220Δ	5.6/9.7	70	318	230	250
MVP 713	4.0	415Δ	9.5	72	318	270	330
MVP 811	5.5	415Δ	12.9	74	530	275	300
MVP 812	7.5	415Δ	16.7	74	530	350	395

TECHNICAL PARAMETERS FOR SINGLE PHASE

MODEL	KW	V	A	NOISE DB	MAX AIR FLOW M ³ /hr.	RATED VACCU Mbar	RATED PRESSURE Mbar
MVP 211	0.37	230 ± 10%	2.6	58	80	110	125
MVP 410	0.75	230 ± 10%	5.8	63	145	140	150
MVP 511	1.1	230 ± 10%	8.2	70	210	170	195
MVP 512	1.5	230 ± 10%	9.8	70	210	190	205

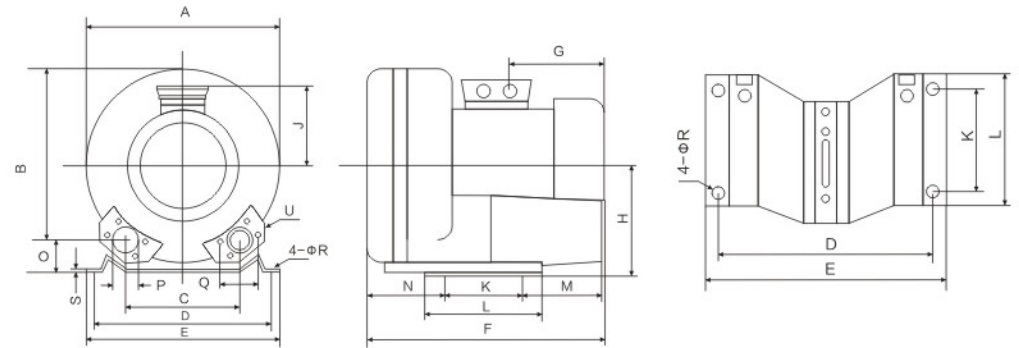

Installation Dimension

MODEL	MVP 210	MVP 410	MVP 510	MVP 610	MVP 710	MVP 810
A	246	286	334	360	400	451
B	247	302	337	366	420	461
C	90	115	120	122	125	152
D	205	225	270	284	310	356
E	230	255	320	325	345	394
F	219	294	314	354	410	450
G	92	160	160	191	250	230
H	128	154	175	192	210	240
J	101	120	120	128	140	148
K	83	95	140	140	140	170
L	108	130	190	180	180	217
M	75	70	96	64	115	140
N	71	75	87	74	110	124
O	39	46	48	56	54	65
P	42	46	55	56	55	---
Q	64	72	83	93	83	---
R	10	12	14	13	15	15
S	2.5	3	4	4.5	4.5	6
U	M6*17	M6*19	M8*17	M8*17	M8*17	---

